

Thank you for your purchase! At MSW® we believe having essential accessories makes a good bike ride great. Tiger Moth 300 is MSW's handy USB rechargeable light set. Keep it on your bike mounted to the handlebars, or easily remove it for safe storage in a commuter backpack or bag. Be seen on your rides!

▲ WARNING: Cycling can be dangerous. Bicycle products should be installed and serviced by a professional mechanic. Never modify your bicycle or accessories. Read and follow all product instructions and warnings including information on the manufacturer's website. Inspect your bicycle before every ride. Always wear a helmet. For more information, please visit www.mswbike.com/safety

COMPATIBILITY AND INTENDED USE

▲ WARNING: Ensure that the Tiger Moth 300 Headlight is placed an adequate distance away from any rotating components of the bicycle or bicycle wheels and is not obstructed by any components, accessories, or cargo.

COMPONENTS

- Light
- USB cable

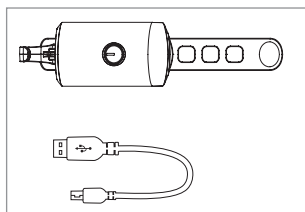

INSTALLATION

Install the bracket onto your handlebar.

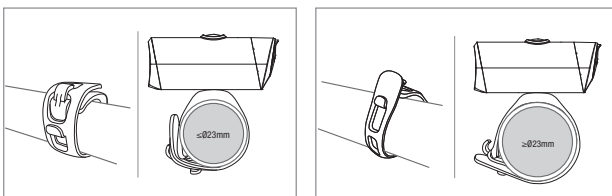
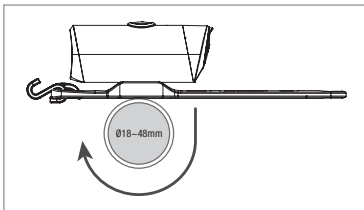

360° ROTABLE BRACKET

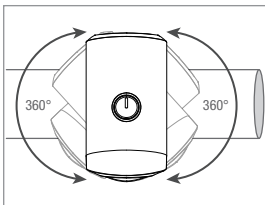

TO SWITCH MODES

Press the button on the top of the light.

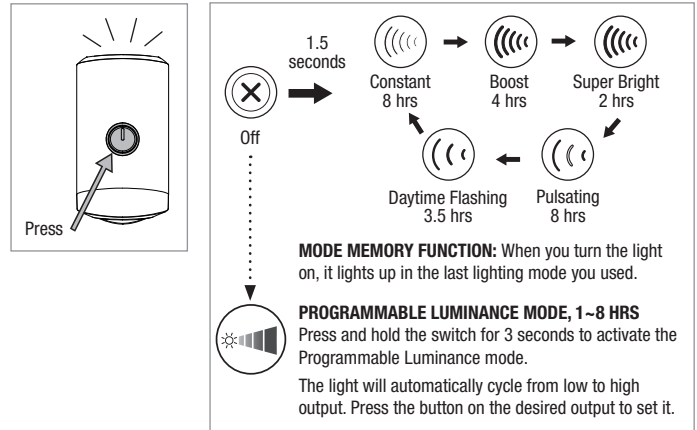

BATTERY CAPACITY INDICATOR

TURN ON: The indicator will show the remaining capacity with different colors.

- Green: 100–50%
- Orange: 49–25%
- Red: 24–0%

TURN OFF: Double click to show the remaining capacity.

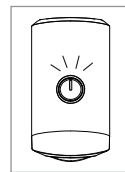

LOW BATTERY INDICATOR

Less than 25% battery remaining

- In constant mode: circular flashing
- In flashing mode: pulsed constant lighting

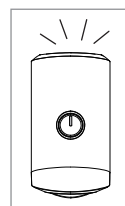

CHARGING

- Open the rubber cover at the bottom of the light.
 - Plug in provided micro USB cable then plug into USB port.
- Red: 0–24%
 - Orange: 25–49%
 - Green: 50–100%
 - Light OFF: Fully Charged

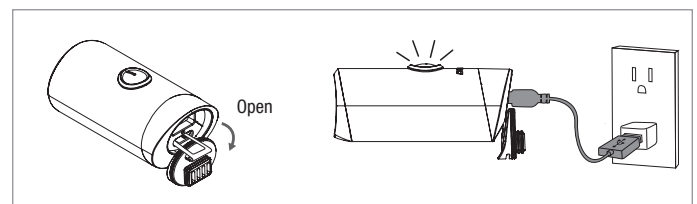

SPECIFICATIONS

Size: 58.8 x 32 x 23.5mm

Weight: 53g

300 Lumen LED: 3 watt white LED

Battery: Rechargeable lithium-ion polymer

Charging: 5V/0.5A, 2.5H

Accessories: Micro USB cable

ONGOING MAINTENANCE

Periodically make sure your light is securely mounted and in working order. Inspect mounting brackets for damage.

LIMITED 2-YEAR WARRANTY

MSW warrants this new MSW product against defects in materials and workmanship for two (2) years from the original date of retail purchase by the consumer. This limited warranty is expressly limited to the repair or replacement of the original product, at the option of MSW, and is the sole remedy of the warranty. This limited warranty applies only to the original purchaser of the MSW product and is not transferable.

In no event shall MSW be liable for any loss, inconvenience or damage, whether direct, incidental or consequential or otherwise resulting from breach of any express or implied warranty or condition of merchantability, fitness for a particular purpose, or otherwise with respect to this product except as set forth herein. This warranty gives the consumer specific legal rights, and those rights and other rights may vary from state to state.

This warranty does not cover the following:

- Damage due to improper assembly or follow-up maintenance or lack of skill, competence or experience of the end user
- Products that have been modified, neglected, used in competition or for commercial purposes, misused or abused, involved in accidents or anything other than normal use
- Damage or deterioration to the surface finish, aesthetics or appearance of the product
- Normal wear and tear
- Labor required to remove and/or refit and re-adjust the product within the bicycle assembly
- Installation of components, parts, or accessories not originally intended for use with or compatible with MSW products.

TO THE EXTENT NOT PROHIBITED BY LAW, THESE WARRANTIES ARE EXCLUSIVE AND THERE ARE NO OTHER EXPRESS OR IMPLIED WARRANTIES OR CONDITIONS INCLUDING WARRANTIES OR CONDITIONS OF MERCHANTABILITY AND FITNESS FOR A PARTICULAR PURPOSE.

WARRANTY PROCESS

If you and your shop think your MSW product is worthy of a warranty inspection, please return the product to the original place of purchase, accompanied by a sales receipt.

For complete warranty information, visit www.mswbike.com/safety/warranty.