

Thank you for your purchase! At MSW® we believe having essential accessories makes a good bike ride great. The MSW Headset Spacer Bell fits seamlessly into your headset stack, leaving your handlebars free for other accessories.

⚠ WARNING: Cycling can be dangerous. Bicycle products should be installed and serviced by a professional mechanic. Never modify your bicycle or accessories. Read and follow all product instructions and warnings including information on the manufacturer's website. Inspect your bicycle before every ride. Always wear a helmet.

For additional product and safety information go to: www.mswbike.com/safety.

INTENDED USE



The MSW Bell is designed to replace one or more spacers between the bicycle headset and stem. The three-step installation procedure requires the removal and replacement of the stem cap, stem and handlebars. If you're not familiar with the procedures shown here, obtain help from a qualified bicycle mechanic.

TOOLS AND SUPPLIES

You will need:

- Headset spacers (if needed)
- 4, 5, 6mm hex-bit sockets
- Torque wrench with Newton-meter scale

INSTALLATION INTRODUCTION

The MSW Bell is designed to replace one or more spacers between the bicycle headset and stem. The three-step installation procedure requires the removal and replacement of the stem cap, stem and handlebars. If you're not familiar with the procedures shown here, obtain help from a qualified bicycle mechanic.

⚠ WARNING: The spacing between the top of the steerer tube and the stem is critical. Failure to maintain the spacing shown below can result in stem/handlebar separation, crash and serious injury.

INSTALLATION STEPS

1. Remove stem cap and stem
2. Swap bell mounting ring in place of existing spacer(s) and reassemble
3. Confirm steerer tube to stem spacing and torque stem cap to specification

STEP 1: REMOVE STEM CAP & STEM

Remove stem bolt and cap and top spacer. Loosen stem bolts and remove stem and handlebars (Fig 1).

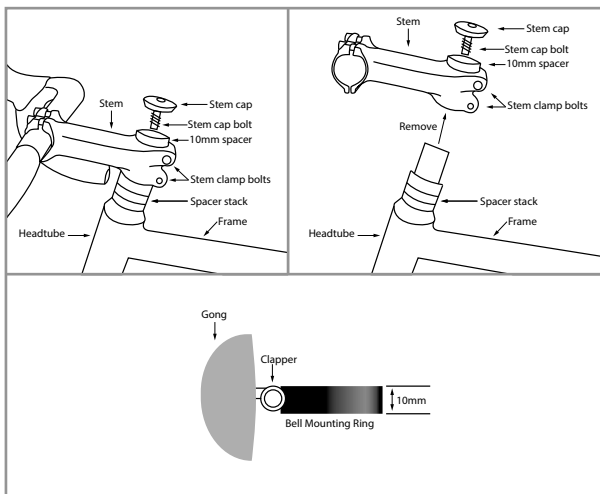

Figure 1

STEP 2: SWAP BELL IN PLACE OF SPACER(S) AND REASSEMBLE

Remove one 10mm spacer or two 5mm spacers and install bell in place of the removed spacer(s) (Fig 2).

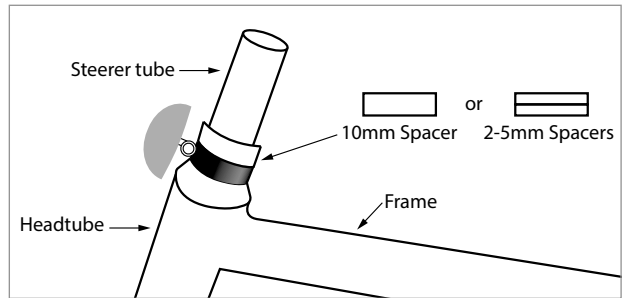

Figure 2

Slide the existing spacer(s), stem and top spacer onto steerer tube (Fig. 3). Rotate bell gong to preferred position on left or right side of steerer tube (Fig. 4). Do not install step bolt and cap at this point.

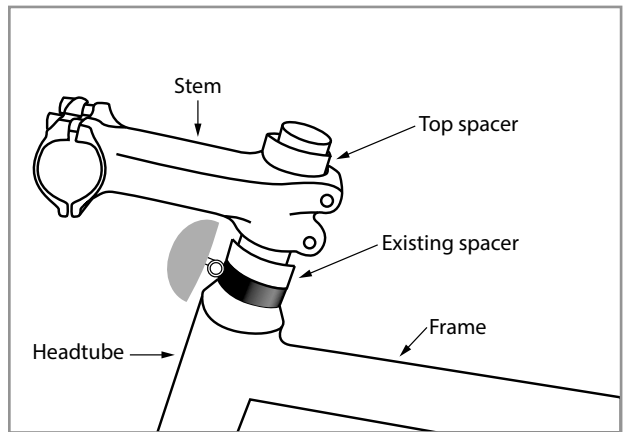

Figure 3

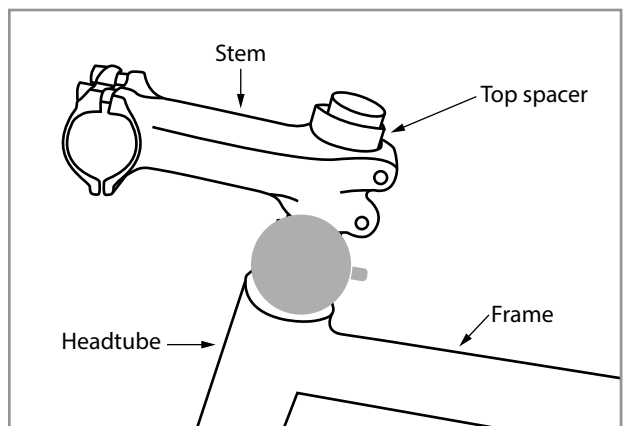

Figure 4

STEP 3: CONFIRM STEERER TUBE-TO-STEM SPACING AND TORQUE STEM CAP TO SPECIFICATION

After reassembly, confirm that the steerer is 3mm below the top spacer (Fig. 5). Add or remove spacers below the stem if required to achieve the 3mm gap. Install stem cap and bolt and torque to manufacturer's specification.

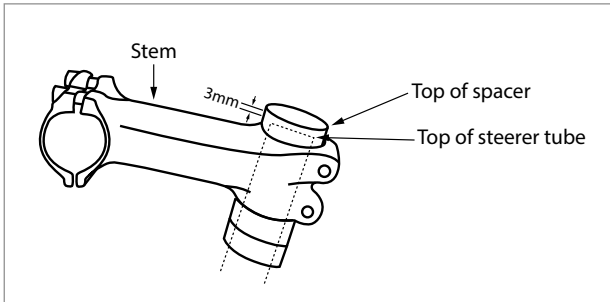

Figure 5

Adjust clapper position by loosening the gong slightly and rotating the clapper to the desired position. Tighten gong while holding the clapper in place (Fig. 6).

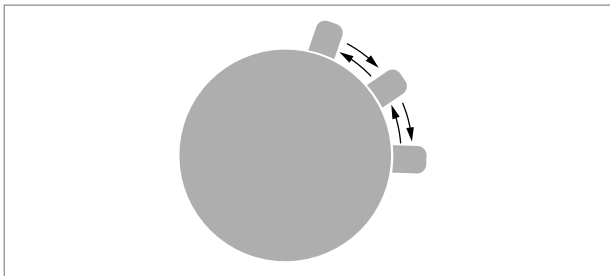

Figure 6

WARRANTY PROCESS

If you and your shop think your MSW product is worthy of a warranty inspection, please return the product to the original place of purchase, accompanied by a sales receipt.

For complete warranty information, visit www.mswbike.com/safety/warranty.